

VACUUM PUMP AND BASE PUMP - VP-26

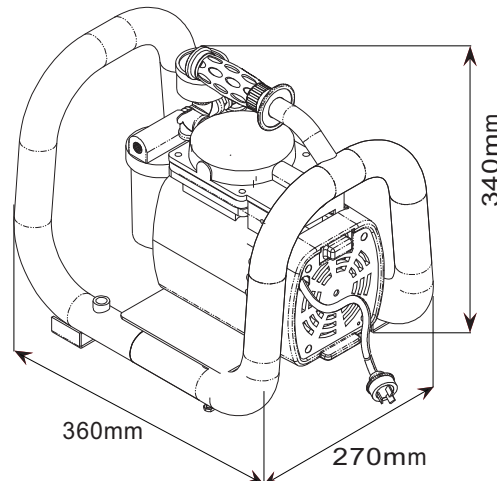

- ◆ Save Time
- ◆ Save Effort
- ◆ Neater Work

Vacuum Pump	
Model	VP-26
Current	1.3 A
Load Speed	1773 pm
Flow Rate	45(L) / min
Vacuum	26.5 in / Hg
Restart Vacuum	25 in / Hg
Dimensions	34x17x25 cm
Weight	8 kg



BASE - VPAS-6-01

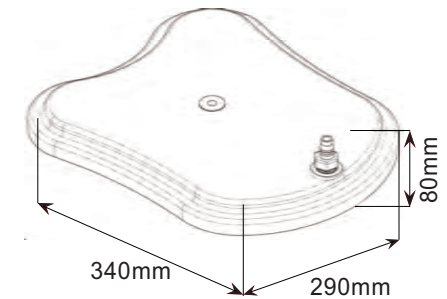
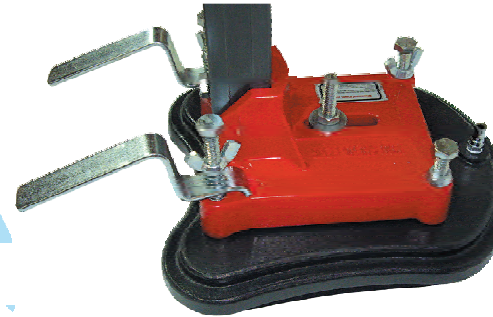

Vacuum Base	
Model	VPAS-6-01
Dimensions	34x29x8 cm
Core Drill Capacity	25-150mm(1"-6")

Compatible with the following Stands
• DR-120
• KF-500
• DF-650
• DF-850

1. **Oilless pump**
2. Works on a **range of Surfaces**.
3. **Saves Time** - No mounting bolt for drill stand required.
4. **No extra clean-up** after the job (no mounting bolt to hide, cut or fill).
5. **Pump frame acts as water trap** to protect the pump
6. **Fast action** - around 20s to seal vacuum on a range of surfaces
7. Vacuum base can be **mounted on walls and floor**
8. **Easy to read** Vacuum Gauge.
9. **High restart vacuum** - If the pump momentarily loses power the VP-26 has a high restart vacuum extending the life of the pump and reducing wait time to restart drilling.